

YE2 series



Contact: Sunny Zhou

Email: sunnyzhou0707@gmail.com

Tel: 0086-13483036671

Skype: juhongcasting

High efficiency three-phase asynchronous motor is in accordance with the standard of GB18613-201

"the energy efficiency standard and energy efficiency level of small and medium-sized three-phase asynchronous motors". This series of motor has high eff

机座号	YD-80	YD-90	YD-100	YD-112	YD-132	YD-160	YD-180	YD-200
轴承前/后	6204/ 6204	6205/ 6205	6206/ 6206	6206/ 6206	6208/ 6208	6309/ 6209	6311/ 6311	6312/ 6212
机座号	YD-225	YD-250	YD-280	YD-315	YD-335			
轴承前/后	6313/ 6313	6314/ 6314	6317/ 6317	N319/ 6319	N322/ 6319			

示意图 Digram												
安装型式 Mounting	B3	B5	B35	V1	V3	V5	V6	B6	B7	B8	V15	V36
机座号 Frame size	H80-355	H80-225	H80-355	H80-355	H80-160							

安装及外形尺寸 INSTALL AND SHAPE DIMENSIONS

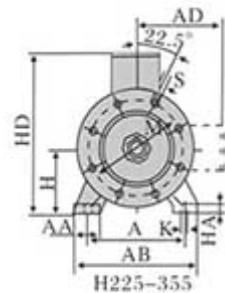
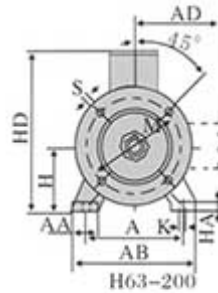
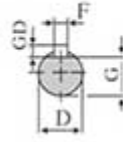
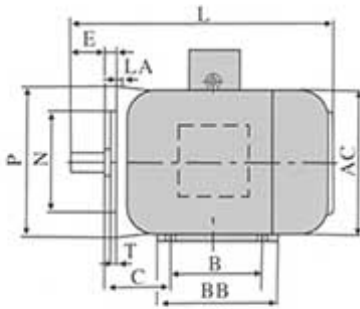

机座号	极数	安装尺寸 (毫米)														外形尺寸 (毫米)									
		H	A	B	C	D	E	F	G	GD	K	M	N	P	S	T	AB	AC	AD	AA	BB	HA	HD	L	LA
80		80	125	100	50	19	40	6	15.5	6	10	165	130	200	12	3.5	165	175	145	34	130	10	214	225	12
90S		90	140	100	56	24	50	8	20	7	10	165	130	200	12	3.5	180	195	155	36	150	12	250	250	12
90L		90	140	125	56	25	50	8	20	7	10	165	130	200	12	3.5	180	195	155	36	165	12	250	290	12
100L		100	160	140	63	28	60	8	24	7	12	215	180	250	15	4	205	215	180	40	180	14	270	320	14
112M		112	190	140	70	28	60	8	24	7	12	215	180	250	15	4	230	240	190	45	180	15	300	350	14
132S		132	216	140	89	38	80	10	33	8	12	265	230	300	15	4	265	275	210	55	190	18	345	390	14
132M	2, 4, 6, 8	132	216	178	89	38	80	10	33	8	12	265	230	300	15	4	265	275	210	55	230	18	345	400	14
160M		160	254	210	108	42	110	12	37	8	15	300	250	350	19	5	320	330	255	65	260	20	420	470	15
160L		160	254	254	108	42	110	12	37	8	15	300	250	350	19	5	320	330	255	65	305	20	420	510	15
180M		180	279	241	121	48	110	14	42.5	9	15	300	250	350	19	5	355	380	280	70	310	22	455	610	17
180L		180	279	279	121	48	110	14	42.5	9	15	300	250	350	19	5	355	380	280	70	355	22	455	655	17
200L		200	318	305	133	55	110	16	49	10	19	350	300	400	19	5	395	410	305	70	375	25	505	700	20
225S	4, 8	225	356	286	149	60	140	18	53	11	19	400	350	450	19	5	435	460	335	75	375	28	555	740	20
225M	2	225	356	311	149	55	110	16	49	10	19	400	350	450	19	5	435	460	335	75	400	28	555	770	20
225M	4, 6, 8	225	356	311	149	60	140	18	53	11	19	400	350	450	19	5	435	460	335	75	400	28	555	815	20
250M	2	250	406	349	168	60	140	18	53	11	24	500	450	550	19	5	490	510	365	80	445	30	615	820	22
250M	4, 6, 8	250	406	349	168	65	140	18	58	11	24	500	450	550	19	5	490	510	365	80	445	30	615	845	22
280S	2	280	457	368	190	65	140	18	58	11	24	500	450	550	19	5	550	580	400	85	490	35	680	845	22
280S	4, 6, 8	280	457	368	190	75	140	20	67.5	12	24	500	450	550	19	5	550	580	400	85	490	35	680	905	22
280M	2	280	457	419	190	65	140	18	58	11	24	500	450	550	19	5	550	580	400	85	540	35	680	905	22
280M	4, 6, 8	280	457	419	190	75	140	20	67.5	12	24	500	450	550	19	5	550	580	400	85	540	35	680	970	22
315S	2	315	508	406	216	65	140	18	58	11	28	600	550	660	24	6	630	645	525	120	570	45	845	970	22
315S	4, 6, 8, 10	315	508	406	216	80	170	22	71	14	28	600	550	660	24	6	630	645	525	120	570	45	845	1025	22
315M	2	315	508	457	216	65	140	18	58	11	28	600	550	660	24	6	630	645	525	120	680	45	845	1025	22
315M	4, 6, 8, 10	315	508	457	216	75	170	22	71	14	28	600	550	660	24	6	630	645	525	120	680	45	845	1215	22
315L	2	315	508	508	216	65	140	18	58	11	28	600	550	660	24	6	630	645	525	120	680	45	845	1215	22
315L	4, 6, 8, 10	315	508	508	216	80	170	22	71	14	28	600	550	660	24	6	630	645	525	120	680	45	845	1325	22
355M	2	355	610	560	254	75	140	20	67.5	12	28	740	680	800	24	6	730	710	655	116	760	52	1010	1495	25
355M	4, 6, 8, 10	355	610	560	254	95	170	25	86	14	28	740	680	800	24	6	730	710	655	116	760	52	1010	1525	25
355L	2	355	610	630	254	75	140	20	67.5	12	28	740	680	800	24	6	730	710	655	116	760	52	1010	1495	25
355L	4, 6, 8, 10	355	610	630	254	95	170	25	86	14	28	740	680	800	24	6	730	710	655	116	760	52	1010	1525	25

技术数据

TECHNICAL DATA

型号	额定功率 (KW/HP)	效率	额定电流 (A)	额定转速 (r/min)	功率因数 (cos φ)	堵转转矩 额定转矩	最大转矩 额定转矩	堵转电流 额定电流
YE2-801-2	0.75	77.4	1.83	2850	0.82	2.3	2.3	6.8
YE2-802-2	1.1	79.6	2.61	2850	0.82	2.3	2.3	7.3
YE2-90S-2	1.5	81.3	3.46	2850	0.83	2.3	2.3	7.6
YE2-90L-2	2.2	83.2	4.58	2850	0.84	2.3	2.3	7.8
YE2-100L-2	3	84.6	6.34	2860	0.86	2.3	2.3	8.1
YE2-112M-2	4	85.8	8.2	2860	0.86	2.3	2.3	8.3
YE2-132S1-2	5.5	87.0	11.1	2870	0.87	2.2	2.3	8.0
YE2-132S2-2	7.5	88.1	14.9	2870	0.88	2.2	2.3	7.8
YE2-160M1-2	11	89.4	21.2	2930	0.88	2.2	2.3	7.9
YE2-160M2-2	15	90.3	28.6	2930	0.88	2.2	2.3	8.0
YE2-160L-2	18.5	90.9	34.7	2930	0.88	2.2	2.3	8.1
YE2-180M-2	22	91.3	41.0	2940	0.88	2.2	2.3	8.2
YE2-200L1-2	30	92	55.4	2950	0.88	2.2	2.3	7.5
YE2-200L2-2	37	92.5	67.9	2950	0.88	2.2	2.3	7.5
YE2-225M-2	45	92.9	82.1	2960	0.88	2.2	2.3	7.6
YE2-250M-2	55	93.2	100	2960	0.88	2.2	2.3	7.6
YE2-280S-2	75	93.8	134	2970	0.88	2.0	2.3	6.9
YE2-280M-2	90	95	160	2970	0.87	2.0	2.3	7.0
YE2-315S-2	110	94.3	195	2970	0.89	2.0	2.2	7.1
YE2-315M-2	132	94.6	233	2970	0.89	2.0	2.2	7.1
YE2-315L1-2	160	94.8	279	2970	0.90	2.0	2.2	7.1
YE2-315L2-2	200	95	348	2970	0.90	2.0	2.2	7.1
YE2-355M1-2	220	95.0	444	2970	0.90	2.0	2.2	7.1
YE2-355M2-2	250	95.0	560	2970	0.90	2.0	2.2	7.1
YE2-801-4	0.55	78	1.57	1390	0.75	2.3	2.3	6.3
YE2-802-4	0.75	79.6	2.03	1440	0.75	2.3	2.3	6.5
YE2-90S-4	1.1	81.4	2.85	1410	0.75	2.3	2.3	6.6
YE2-90L-4	1.5	82.8	3.67	1410	0.75	2.3	2.3	6.9
YE2-100L1-4	2.2	84.3	5.09	1440	0.80	2.3	2.3	7.5
YE2-100L2-4	3	85.5	6.73	1440	0.81	2.3	2.3	7.6
YE2-112M-4	4	86.6	8.8	1450	0.81	2.3	2.3	7.7
YE2-132S-4	5.5	87.7	11.7	1450	0.81	2.0	2.3	7.5
YE2-132M-4	7.5	88.7	15.6	1450	0.82	2.0	2.3	7.4
YE2-160M-4	11	89.8	22.2	1460	0.84	2.2	2.3	7.5
YE2-160L-4	15	90.6	30.0	1460	0.85	2.2	2.3	7.5

型号	额定功率 (KW/HP)	效率 (%)	额定电流 (A)	额定转速 (r/min)	功率因数 (cos ϕ)	堵转转矩 额定转矩	最大转矩 额定转矩	堵转电流 额定电流
YE2-180M-4	18.5	91.2	36.7	1460	0.85	2.2	2.3	7.7
YE2-180L-4	22	91.6	43.4	1470	0.85	2.2	2.3	7.8
YE2-200L-4	30	92.3	58.0	1470	0.85	2.2	2.3	7.2
YE2-225S-4	37	92.7	70.2	1480	0.85	2.2	2.3	7.3
YE2-225M-4	45	93.1	85.0	1480	0.85	2.2	2.3	7.4
YE2-250M-4	55	93.5	103	1480	0.85	2.2	2.3	7.4
YE2-280S-4	75	94.0	140	1480	0.87	2.2	2.3	6.7
YE2-280M-4	90	94.2	167	1480	0.87	2.2	2.3	6.9
YE2-315S-4	110	94.5	201	1480	0.87	2.2	2.2	6.9
YE2-315M-4	132	94.7	240	1480	0.87	2.2	2.2	6.9
YE2-315L1-4	160	94.9	287	1480	0.88	2.2	2.2	6.9
YE2-315L2-4	200	95.1	360	1480	0.88	2.2	2.2	6.9
YE2-355M-4	220	95.1	443	1480	0.89	2.2	2.2	6.9
YE2-355L-4	250	95.1	558	1480	0.89	2.2	2.2	6.9
YE2-90S-6	0.75	75.9	2.29	960	0.71	2.1	2.1	5.8
YE2-90L-6	1.1	78.1	3.18	960	0.72	2.1	2.1	5.9
YE2-100L-6	1.5	79.8	3.94	960	0.73	2.1	2.1	6.0
YE2-112M-6	2.2	81.8	5.6	960	0.73	2.0	2.1	6.0
YE2-132S-6	3	83.3	7.4	960	0.73	2.0	2.1	6.2
YE2-132M1-6	4	84.6	9.8	960	0.73	2.0	2.1	6.8
YE2-132M2-6	5.5	86.0	12.9	970	0.74	2.0	2.1	7.1
YE2-160M-6	7.5	87.2	17.0	970	0.77	2.1	2.1	6.7
YE2-160L-6	11	88.7	24.2	970	0.78	2.1	2.1	6.9
YE2-180L-6	15	89.7	31.6	980	0.80	2.0	2.1	7.2
YE2-200L1-6	18.5	90.4	38.6	980	0.80	2.1	2.1	7.2
YE2-200L2-6	22	90.9	44.7	980	0.81	2.1	2.1	7.3
YE2-225M-6	30	91.7	59.3	980	0.80	2.1	2.1	7.1
YE2-250M-6	37	92.2	71	980	0.83	2.1	2.1	7.1
YE2-280S-6	45	92.7	86	980	0.85	2.1	2.1	7.2
YE2-280M-6	55	93.1	105	980	0.85	2.1	2.0	7.2
YE2-315S-6	75	93.7	141	980	0.84	2.0	2.0	6.7
YE2-315M-6	90	94.0	169	980	0.83	2.0	2.0	6.7
YE2-315L1-6	110	94.3	206	980	0.84	2.0	2.0	6.7
YE2-315L2-6	132	94.6	244	980	0.85	2.0	2.0	6.7
YE2-355M1-6	160	94.8	292	980	0.86	2.0	2.0	6.7
YE2-355M2-6	200	95.0	365	980	0.86	2.0	2.0	6.7
YE2-355L-6	320	95.0	457	980	0.86	2.0	2.0	6.7

型号	额定功率 (KW/HP)	效率 (%)	额定电流 (A)	额定转速 (r/min)	功率因数 (cos φ)	堵转转矩 额定转矩	最大转矩 额定转矩	堵转电流 额定电流
YE2-80M1-8	0.18	51.0	0.88	645	0.61	1.8	1.9	3.3
YE2-80M2-8	0.25	54.0	1.15	645	0.61	1.8	1.9	3.3
YE2-90S-8	0.37	62.0	1.49	670	0.61	1.8	1.9	4.0
YE2-90L-8	0.55	63.0	2.17	670	0.61	1.8	2.0	4.0
YE2-100L1-8	0.75	71.0	2.39	680	0.67	1.8	2.0	4.0
YE2-100L2-8	1.1	73.0	3.37	680	0.69	1.8	2.0	5.0
YE2-112M-8	1.5	75.0	4.5	690	0.69	1.8	2.0	5.0
YE2-132S-8	2.2	78.0	6.0	705	0.71	1.8	2.0	6.0
YE2-132M-8	3	79.0	7.9	705	0.73	1.8	2.0	6.0
YE2-160M1-8	4	81.0	10.3	720	0.73	1.9	2.0	6.0
YE2-160M2-8	5.5	83.0	13.6	720	0.74	2.0	2.0	6.0
YE2-160L-8	7.5	85.5	17.8	720	0.75	2.0	2.0	6.0
YE2-180L-8	11	87.5	25.1	730	0.76	2.0	2.0	6.6
YE2-200L-8	15	88.0	34.1	730	0.76	2.0	2.0	6.6
YE2-225S-8	18.5	90.0	41.1	730	0.76	1.9	2.0	6.6
YE2-225M-8	22	90.5	47.4	730	0.78	1.9	2.0	6.6
YE2-250M-8	30	91.0	64	735	0.79	1.9	2.0	6.6
YE2-280S-8	37	91.5	78	735	0.79	1.9	2.0	6.6
YE2-280M-8	45	92.0	94	735	0.79	1.8	2.0	6.6
YE2-315S-8	55	92.8	110	735	0.81	1.8	2.0	6.6
YE2-315M-8	75	93.0	151	735	0.81	1.8	2.0	6.6
YE2-315L1-8	90	93.8	178	735	0.82	1.8	2.0	6.6
YE2-315L2-8	110	94.0	217	735	0.82	1.8	2.0	6.4
YE2-355M1-8	132	93.7	261	740	0.82	1.8	2.0	6.4
YE2-355M2-8	160	94.2	315	740	0.82	1.8	2.0	6.4
YE2-355L-8	200	94.5	388	740	0.83	1.8	2.0	6.4
YE2-315S-10	45	91.5	100	590	0.75	1.5	2.0	6.2
YE2-315M-10	55	92.0	121	590	0.75	1.5	2.0	6.2
YE2-315L1-10	75	92.5	162	590	0.76	1.5	2.0	6.2
YE2-315L2-10	90	93.0	191	590	0.77	1.5	2.0	6.2
YE2-355M1-10	110	93.2	230	590	0.78	1.3	2.0	6.0
YE2-355M2-10	132	93.5	275	590	0.78	1.3	2.0	6.0
YE2-355L-10	160	93.5	334	590	0.78	1.3	2.0	6.0